

CG-901PA1V

Home | Security | Cameras | Boxed

CG-901PA1V
1/3" Day/Night Multifunction Camera with WDR, OSD,
DSS, 12VDC/24VAC, 650TVL

Art-Nr. 92549



Lens not included

Main Features

Wide dynamic range (WDR): 60dB	High and low speed shutter control (ESC/DSS)
On-screen menu control / camera title display	Auto blemish compensation function
Removable IR cut filter w. "detect time" function	4x e-zoom and flickerless function
Sensitivity of 0.3Lux at F1.2 (colour)	Automatic White Balance with Hold Function (AWB)
2D & 3D Digital noise reduction (DNR)	RS-485 interface / external day&night selection
Motion detection & face recognition function	Supply Voltage: 12VDC or 24VAC

Specifications

System	day&night
Video standard	CCIR/PAL
Sensor size	1/3"
Imager	CCD, Sony Super HAD II PS 960H Interline Transfer
Active picture elements	570,000, 950(H) x 596(V)
Horizontal resolution	650 TVL
Synchronization	Internal/Line lock (via OSD menu)
Signal-to-noise ratio	50dB (AGC OFF)
Gamma correction	0.45 (CRT), 0.6 (LCD), 1.0 (OFF)
Sensitivity (at 50% video signal)	0,3 Lux, at F1.2 (colour); 0.04 Lux at F1.2 (B&W)
Automatic gain control (AGC)	OFF / Low / High selectable
Automatic electronic shutter (ESC)	no
Manual electronic shutter (MES)	1/50 ~ 1/100,000sec.

CG-901PA1V

(Continuation Specifications)

Low speed shutter	yes, automatic, 2 ~40 Fields, OFF
Digital Noise Reduction (DNR)	yes, 2D & 3D
Backlight compensation	BLC, ON/OFF switchable (via OSD menu)
Wide Dynamic Range (WDR)	yes, 60db
White balance	automatic/manually/Hold (2500K - 6500K)
Blemish compensation	Automatic blemish detection and compensation
Aperture Correction (APC)	horizontal and vertical
Flickerless function	On/Off switchable (via OSD menu)
IR cut filter	switchable
Day/Night switching	automatic and manual
Privacy zones masking	8 zones masking
OSD function control	OSD camera setup: WDR, DSS, Shutter, Day/Night, E-Zoom, BLC, AWB, DNR (2D&3D), AGC, Flickerless, Brightness, Sharpness, Masking (Window blanking), Blemish compenstion, Motion & Face detection, Sync. selection, 20 characters camera title
Motion detector	integrated
Digital zoom	1x ~4x
Lens mount	CS mount
Iris control	Manual iris, DC controlled
Illumination	no
External adjustments	Flange focus, 4 menu cursor buttons, RS-485 termination ON/OFF switch
Video outputs	composite (CVBS), 1Vp-p, (C)VBS, 75ohms, BNC
External connections	DC Iris (4 pin), Video (BNC), Power input, RS-485 interface
Serial interfaces	RS-485
Camera mount	1/4" - 20 UNC thread on top and bottom
Supply voltage	12VDC, 24VAC, (+/-15%) 50Hz
Power consumption	approx. 4.7watts at 12VDC 6.5watts at 24VAC
Housing	indoor
Colour	similar to RAL7048
Hidden cable management	no
Protection rating	IP40
Temperature range (operation)	-10°C ~+50°C
Dimensions (HxWxD)	see drawing
Weight	200g
Parts supplied	4 pin Lens plug, Allen wrench key, Control adapter cable with open ends, Quick start guide and manual on CD
Certificates	CE

Optional accessories

CG-901PA1V

43274	F03Z2.6DC-NFSHR	F1.0/3-8mm DC Lens, Varifocal, No Focus Shift, High Resolution, 1/3"CS Mount
70769	WD-22	Wall Mount Bracket with Ball Joint, 1/4"Camera Fixing Screw, Beige Grey
70495	VT-PS12DC-7	Plugable PSU w. Cont. & UK Mains plug-in 100-240VAC/12VDC-1.25A, Regulated
77773	VT-PS12DCDT1	PSU 12VDC/1.0A, Regulated, Desktop Version, 1.8m Cables each w. open ends
70536	VT-PS12DC-9	Plug-in Power Supply Unit 100-240VAC 12VDC (1.0Amp), Regulated, w. open Ends
45246	YV5X2.7R4B-SA2L	F1.3/2.7-13.5mm DC Varifocal Lens, No Focus Shift, 1/3"CS Mount
43238	F03Z2.710DC-NFS	F1.0/3-8mm DC Lens/var. Focal Length with No Focus Shift, 1/3"CS Mount
43106	C/CS RING-AL	Adapter Ring, C/CS Mount, Aluminium anodized
43249	F07Z07NDDC-NFS	F1.3/7.5-50mm DC Lens/var. Focal Length with No Focus Shift, 1/3"CS Mount
43239	A10Z04NDDC-NFS	F1.4/10-40mm DC Lens/var. Focal Length with No Focus Shift, 1/2"C Mount
74089	EDC-CR1	Converter RS-232/RS-485, Repeater RS-485
70771	WD-23	Wall Mount Bracket with Ball Joint, 1/4"Camera Fixing Screw, Pantone 877

CG-901PA1V

Product information

The Fujitsu CG-901P day/night camera is based on a Sony SS4 DSP and a double-scan interline-transfer CCD. This type of CCD takes each image twice, using first a normal shutter speed and then a fast one. Subsequently, the dark and light areas of the image obtained using the different shutter speeds are combined to form an image that is rich in contrast, with a wide dynamic range (WDR). This exposure technique achieves backlight compensation which, in comparison with normal BLC, makes it possible to expose both the light and the dark areas of the image in the optimal manner. In the large number of practical tests carried out to date, we have not been able to reproduce any scene with lighting so extreme that the Fujitsu WDR CG-901P model has not been able to cope. The camera's other outstanding properties include: integrated motion and face detection, pixel-error compensation, alarm contact output, RS-485 interface, 2D&3D noise suppression, electronic zoom function, OSD menu, display titles, masking, pre-set parameters and exposure programmes.

CG-901PA1V

Home | Security | Cameras | Boxed

Technical drawing

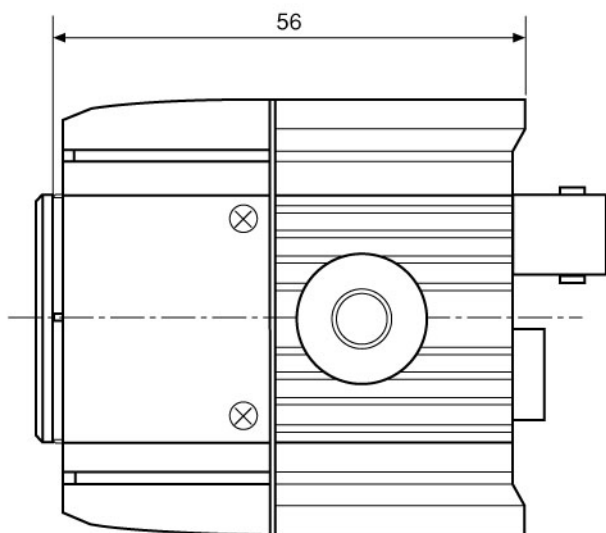
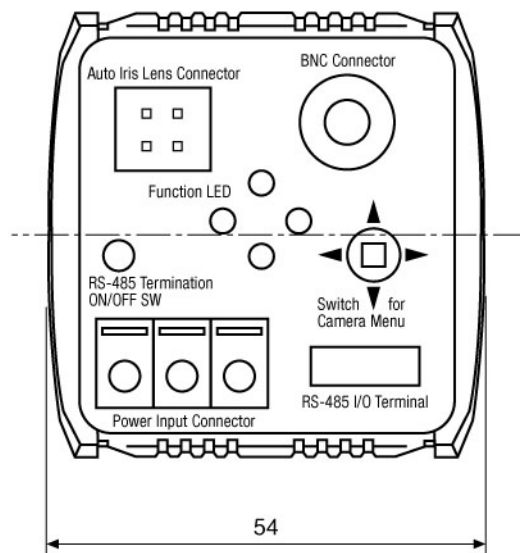
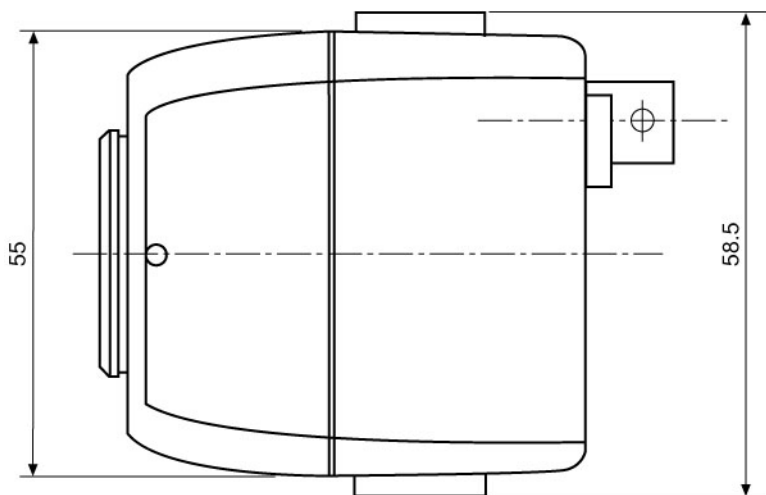

Maße/Dimensions: mm

SLD Security & Communications
The Old Forge, Ockham Lane, Ockham, Surrey GU236PH England
Phone +44.1483225633 · Fax +44.1483225634
sales@sld.co.uk · www.sld.co.uk

