

# Video Security



## VKCD-1323/IR

1/3" Day&Night Dome Camera with DNR, IR Illumination, F1.2/3.8-9.5mm, 540TVL

**Art-No. 92164**



## Features

1/3" Super HAD Colour/B&W CCD Sensor  
 Integrated F1.2/3.8-9.5mm Varifocal DC Iris Lens  
 Digital Noise Reduction (DNR)  
 Removable IR Cut Filter  
 Sensitivity of 0.1Lux at F1.2 (Colour)  
 Backlight Compensation (BLC) / Flickerless ON/OFF

Automatic Gain Control (AGC)  
 Automatic White Balance (ATW/AWB)  
 IR Illumination by 36 integrated 850nm LEDs  
 Manual 3-axis Camera Gimbal  
 Supply Voltage 12VDC or 24VAC  
 For Wall and Ceiling Flush and Surface Mount

## Specifications

<b>Video standard</b>	CCIR/PAL
<b>System</b>	day&night
<b>Sensor size</b>	1/3"
<b>Imager</b>	CCD, Sony Super HAD Interline Transfer CCD
<b>Synchronization</b>	Internal
<b>Signal-to-noise ratio</b>	48dB
<b>Sensitivity (at 50% video signal)</b>	0,13Lux, at F1.2 (colour); 0.07Lux at F1.2 (B&W)
<b>Horizontal resolution</b>	520TVL, (colour), 550 TV lines (B&W)
<b>Rotation range</b>	manual: 360°
<b>Window blanking</b>	4 dynamic window blanking zones with user-defined four-sided shapes and up to 15-character labels each
<b>Automatic gain control (AGC)</b>	Off/Low/Mid/High selectable
<b>Integration rate</b>	yes
<b>Digital Noise Reduction (DNR)</b>	off/low/middle/high selectable
<b>White balance</b>	Automatic and Manual
<b>Backlight compensation</b>	BLC, Adjustable: Max / Mid / Min and OFF
<b>Aperture Correction (APC)</b>	Horizontal and vertical

(Specifications continued)

<b>IR cut filter</b>	yes, Motorized, switchable filter. Automatic function depend on the amount of light. In removed filter position, the colour signal, will be switched OFF
<b>Video outputs (type)</b>	CVBS, VBS
<b>Video outputs</b>	1Vp-p, (C)VBS, 75ohms, BNC
<b>Lens mount</b>	integrated lens
<b>Lens type</b>	varifocal
<b>Lens</b>	F1.2/F2.0~360 / 3.8~9.5mm with galvanometer controlled iris
<b>Application range</b>	security, industrial
<b>Nominal format size</b>	1/3"
<b>Aspherical technology</b>	yes
<b>Focal length</b>	3,8-9,5mm
<b>Horizontal angle of view</b>	74,2-30°
<b>Iris control</b>	DC
<b>Filter screw size</b>	not available
<b>Mount</b>	n/a
<b>Illumination</b>	36 LEDs 850nm. Integrated light sensor for On/Off switching of the illumination
<b>Illumination range</b>	15m (at a good light reflexion and 40% Videosignal)
<b>OSD function control</b>	Brightness (DC), Backlight Compensation, Electronic shutter (DSS), Manual high speed shutter (1/50 to 1/120,000), Automatic white balance, Manual white balance (Red/Blue), AGC, DNR, Motion Detection, Flickerless mode, Privacy window, Mirror, Sharpness, Day/Night
<b>External connections</b>	Video (BNC), 12 VDC (terminal block), Service Monitor Output
<b>Serial interfaces</b>	no
<b>Temperature range (Operation)</b>	-10° ~ +50°C
<b>Heater</b>	optional
<b>Protection rating</b>	IP66
<b>Supply voltage</b>	12VDC, 24VAC, (+/-10%)
<b>Power consumption</b>	8.5watts max.(12V, IR LEDs On)
<b>Vandalism resistant</b>	yes
<b>Colour (bubble)</b>	clear
<b>Camera fixing</b>	no
<b>Mounting</b>	wall mount, surface mount, in-ceiling mount
<b>Housing</b>	outdoor housing
<b>Housing material</b>	aluminium
<b>Colour (housing)</b>	Pantone Warm Gray 1C
<b>Weight</b>	1.0kg
<b>Parts supplied</b>	Mounting kit, Torx wrench key, Blind cover 3/4"

## Accessories

<b>92168 / IRCAM/WB2</b>	Wall Mount Kit for VKCD-1323/IR, VKCD-1322 and VKCD-1324/IR
<b>92209 / IRCAM/CB1</b>	Ceiling Mount Kit for VKCD-1323/IR, VKC-1322 and VKC-1324/IR
<b>70447 / VT-PS12DC-5</b>	Plug-in Power Supply Unit 100-240VAC 12VDC (1.0Amp), Regulated, with DC Plug
<b>77773 / VT-PS12DCDT1</b>	PSU 12VDC/1.0A, Regulated, Desktop Version, 1.8m Cables each w. open ends
<b>70495 / VT-PS12DC-7</b>	Plugable PSU w. Cont. & UK Mains plug-in 100-240VAC/12VDC-1.25A, Regulated
<b>70527 / NE-132/AC24V</b>	Power Supply Unit 230VAC/24VAC (1.0A)
<b>88149 / 3/4" - M25X1.5</b>	Thread Adapter 3/4" - Conduit Connection M25x1.5mm for Dome Surface Mount Housing
<b>92165 / VKCD-1323/IR-KB</b>	External Remote Control Board for VKCD-1323/IR

Einbau / Flush Mount

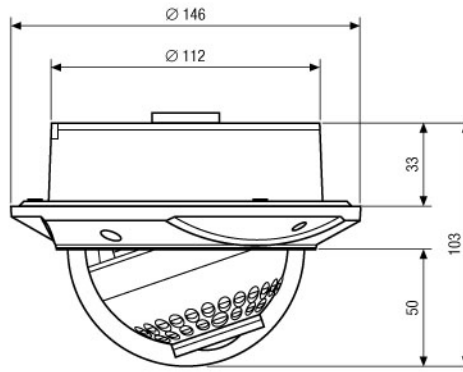
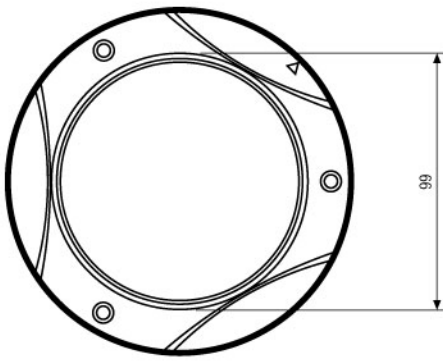

Aufbau / Surface Mount

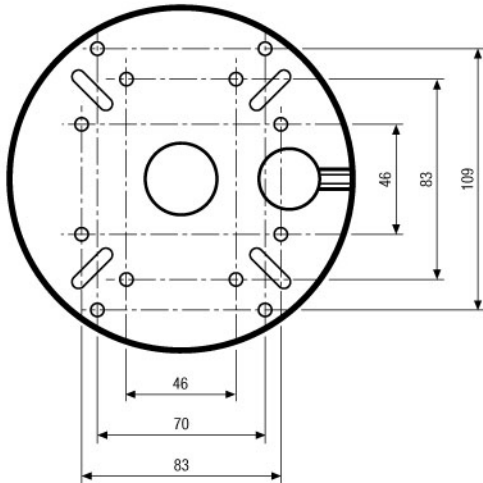
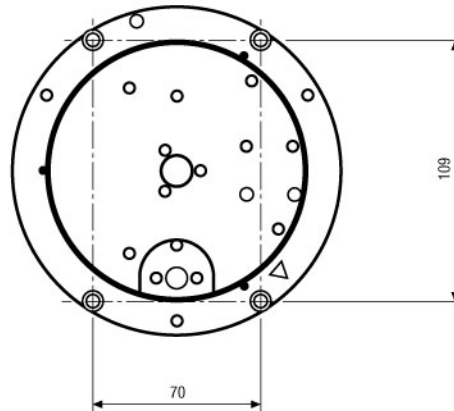
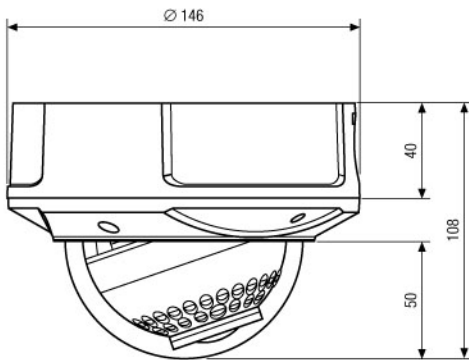

Maße/Dimensions: mm

SLD Security & Communications  
 The Old Forge, Ockham Lane, Ockham, Surrey GU236PH England  
 Phone +44.1483225633 · Fax +44.1483225634  
 sales@sld.co.uk · www.sld.co.uk

